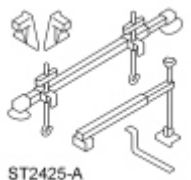

Engine Support Insulators

Special Tool(s)

 <p>ST1595-A</p>	Lifting Bracket, Engine 303-050 (T70P-6000)
 <p>ST2425-A</p>	Support Bar, Engine 303-F072

Material

Item	Specification
Motorcraft® Metal Surface Prep ZC-31-A	—

Generator and Radiator Sight Shield

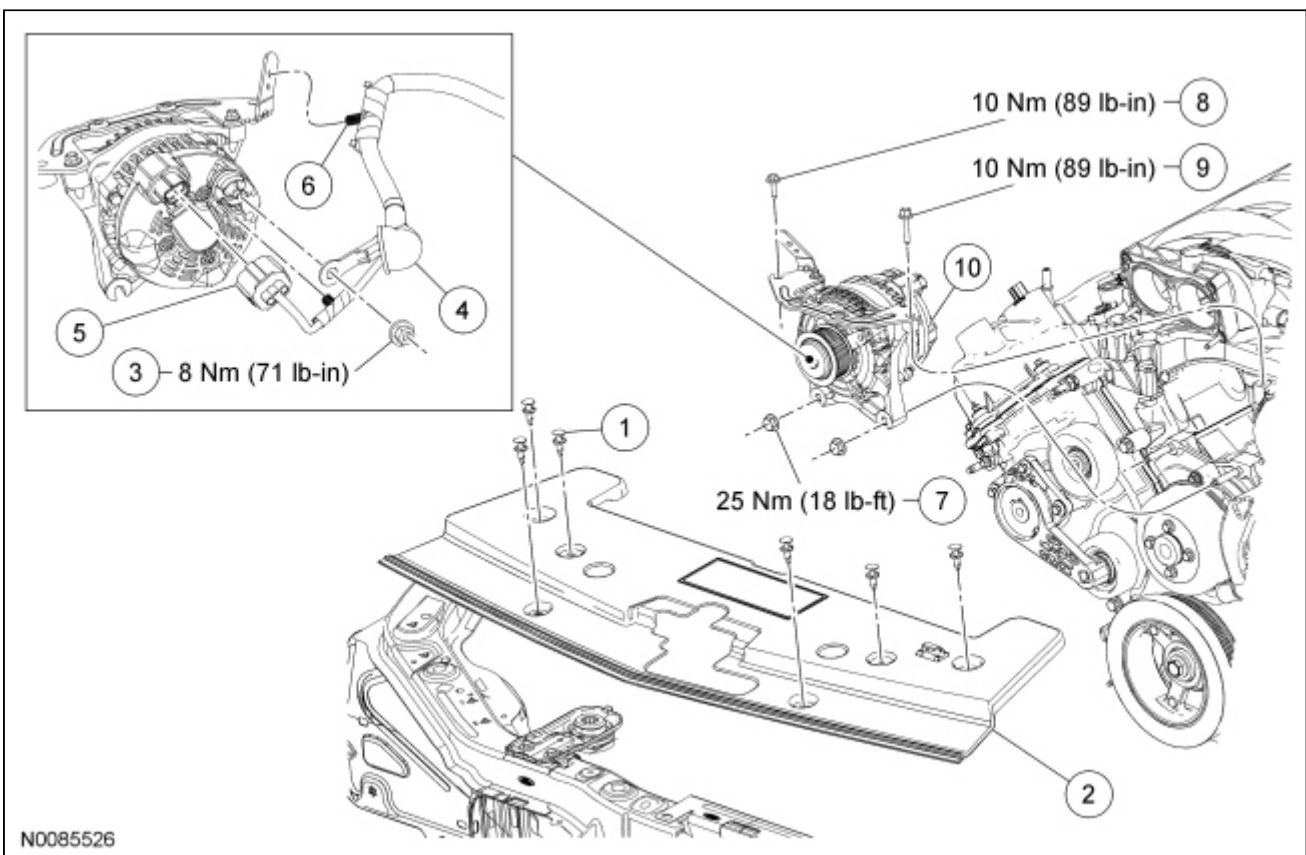

Item	Part Number	Description
1	—	Pin-type retainer

2	8C291	Radiator sight shield
3	W705790	B+ terminal nut
4	—	B+ terminal cover (part of 14305)
5	14A4644	Generator electrical connector (part of 14305)
6	—	Wiring harness pin-type retainer (2 required) (part of 14305)
7	N804758	Generator nut (2 required)
8	N807309	Generator bracket bolt
9	W704682	Generator bracket bolt
10	10300	Generator

RH Engine Support Insulators

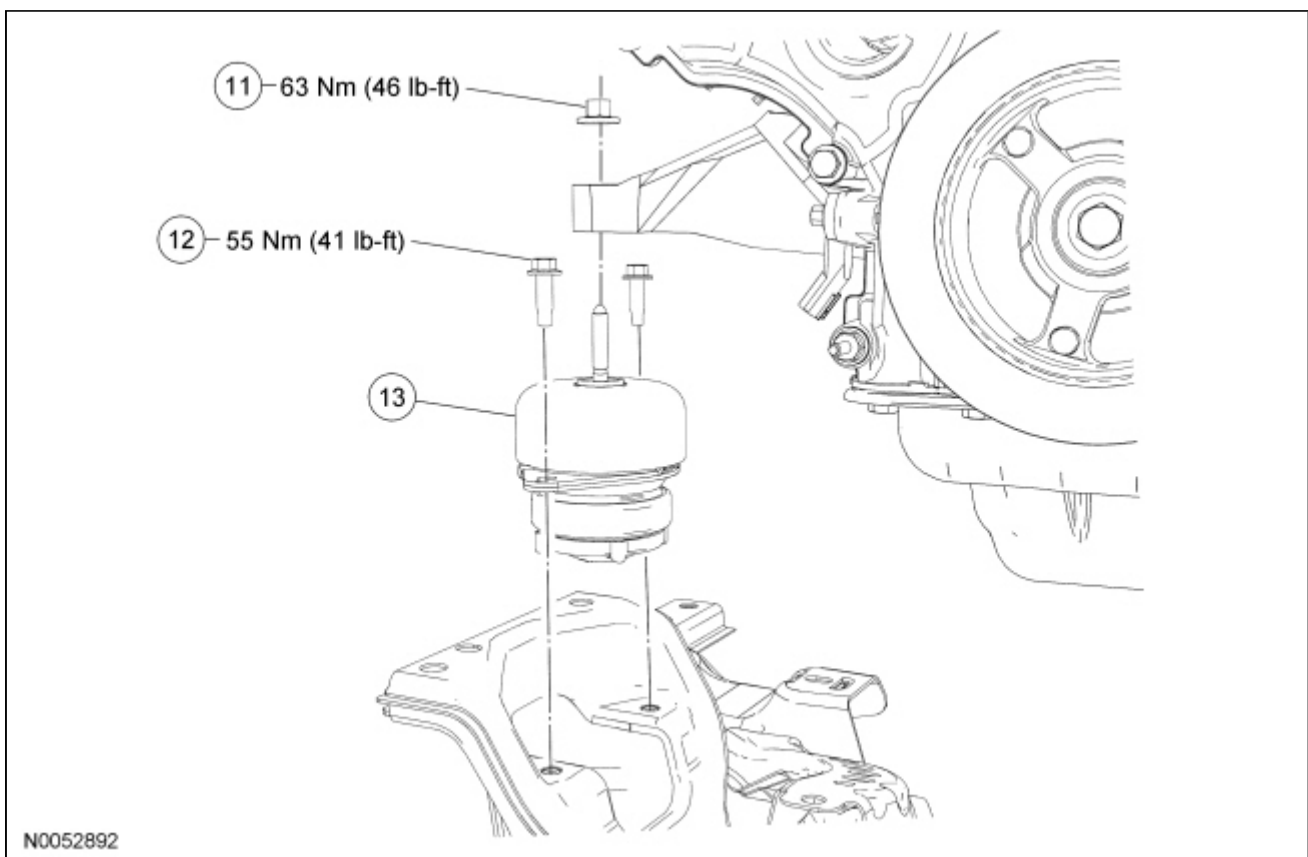

Item	Part Number	Description
11	N621943	RH engine support insulator nut
12	W707641	RH engine support insulator bolt (2 required)
13	6038	RH engine support insulator

LH Engine Support Insulators

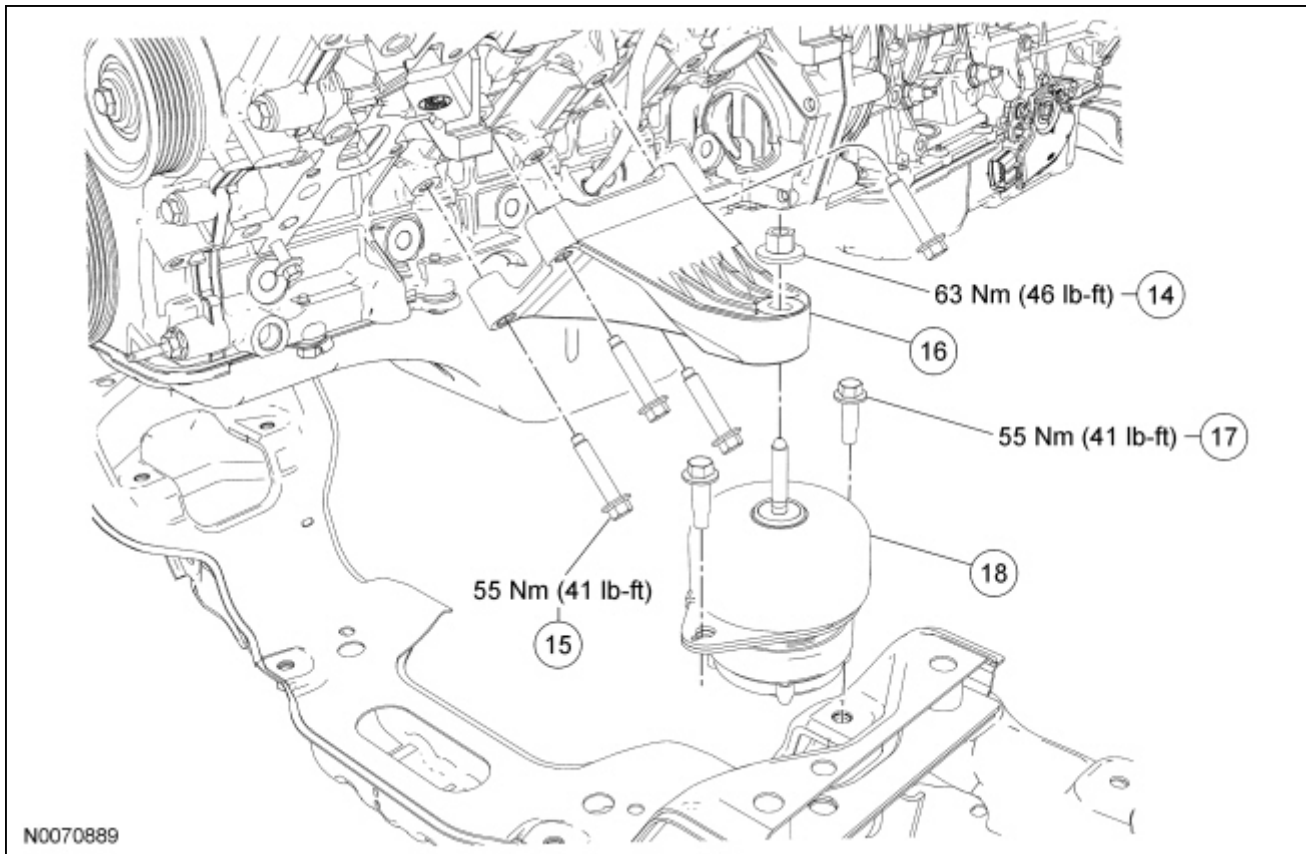

Item	Part Number	Description
14	N621943	LH engine support insulator nut
15	W500721	LH engine support bracket bolt (4 required)
16	6B033	LH engine support bracket
17	W707641	LH engine support insulator bolt (2 required)
18	6038	LH engine support insulator

Removal

1. With the vehicle in NEUTRAL, position it on a hoist. For additional information, refer to [Section 100-02](#).
2. Disconnect the battery ground cable. For additional information, refer to [Section 414-01](#).
3. Remove the Air Cleaner (ACL) assembly. For additional information, refer to [Section 303-12](#).
4. Remove the Throttle Body (TB). For additional information, refer to [Section 303-04B](#).
5. Disconnect the Evaporative Emission (EVAP) canister purge valve vapor tube quick connect coupling from the intake manifold and position aside. For additional information, refer to [Section 310-00](#).

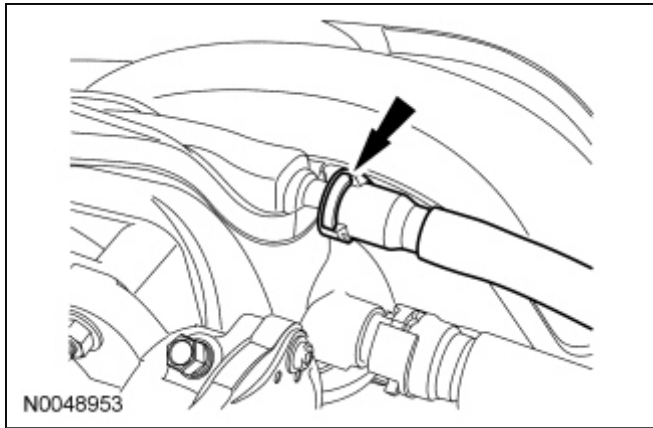

6. Remove the 6 pin-type retainers and the radiator sight shield.
7. Remove the 2 outer generator bracket bolts.
8. Remove the 2 lower generator nuts.
9. Disconnect the generator electrical connector and pin-type retainers.
10. Position the B+ terminal cover aside and remove the B+ terminal nut.
 - Remove the generator.
11. Install the Engine Lifting Brackets.

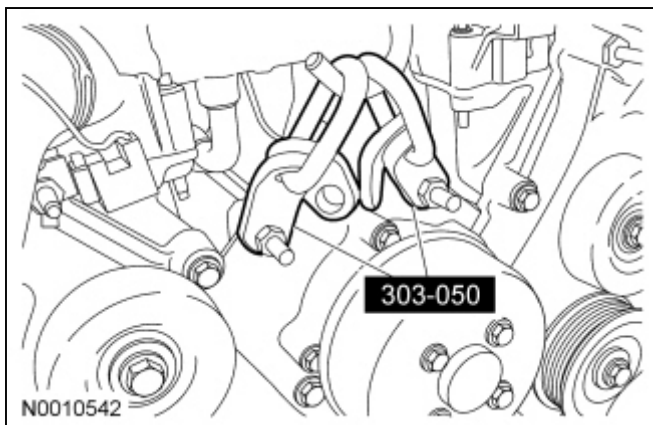

12. If equipped, remove the 4 nuts and the strut tower cross brace.

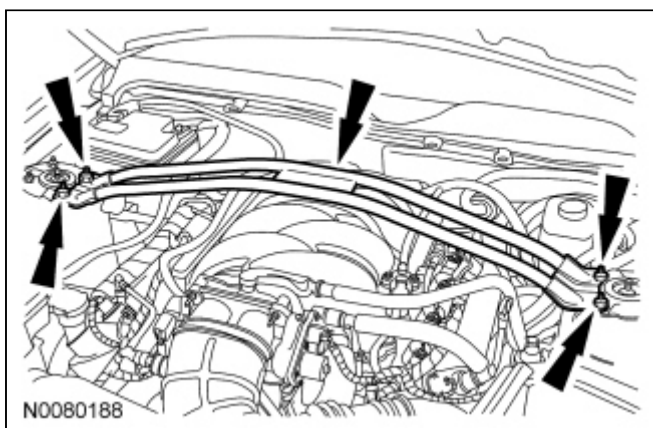

13. Install the Engine Support Bar.

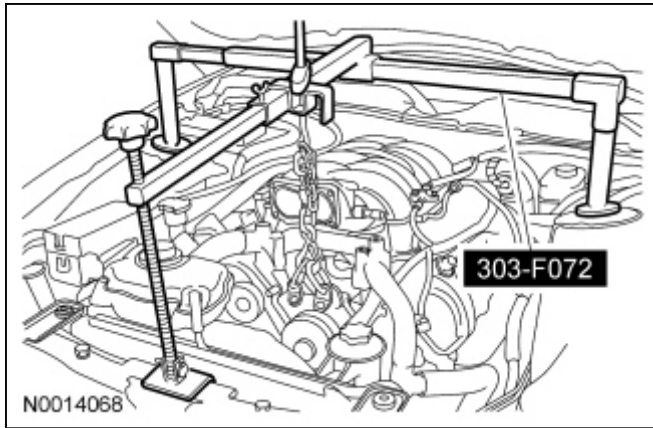

14. **NOTE:** Both the RH and LH engine support insulator nuts must be removed to allow the engine to be raised.

NOTE: RH shown, LH similar.

Remove the RH and LH engine support insulator nuts.

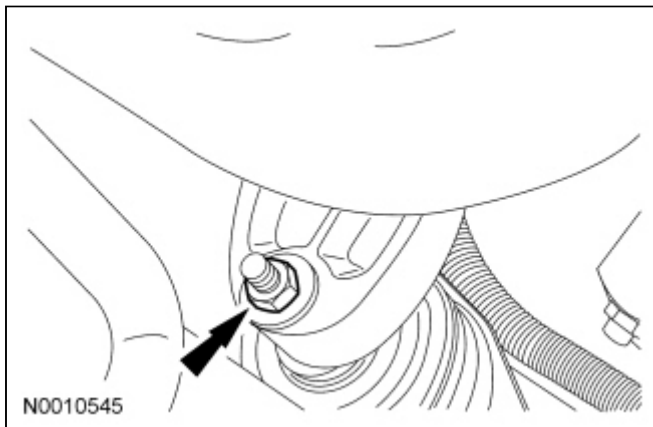

15. Using the Engine Support Bar, raise the engine 40 mm (1.57 in).

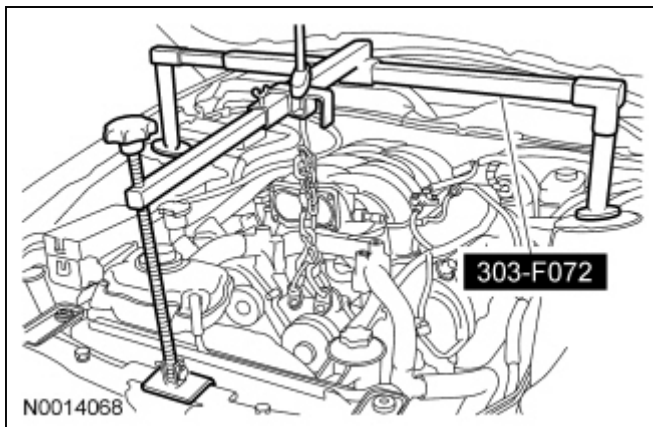

16. Remove the 2 engine support insulator-to-subframe bolts.
- Remove the RH engine support insulator.
17. Remove the 4 bolts and the LH engine support bracket.
18. Remove the 2 engine support insulator-to-subframe bolts.
- Remove the LH engine support insulator.

Installation

1. Install the LH engine support insulator and 2 engine support insulator-to-subframe bolts.
 - Tighten to 55 Nm (41 lb-ft).
2. Install the LH engine support bracket and 4 bolts.
 - Tighten to 55 Nm (41 lb-ft).
3. Install the RH engine support insulator and 2 engine support insulator-to-subframe bolts.
 - Tighten to 55 Nm (41 lb-ft).
4. Using the Engine Support Bar, lower the engine.

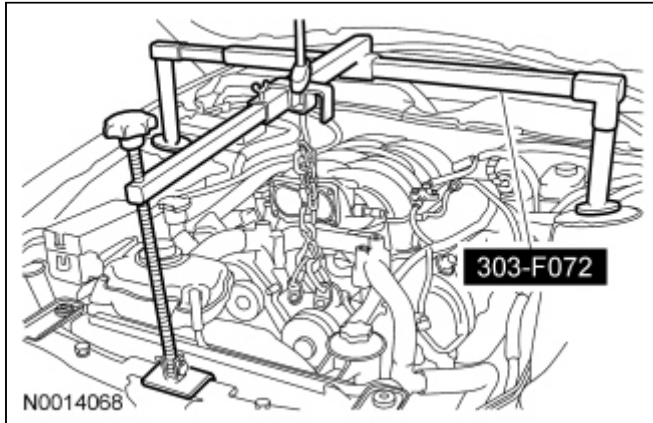

5. If equipped, install the 4 nuts and the strut tower cross brace.
 - Tighten to 35 Nm (26 lb-ft).
6. **NOTE:** RH shown, LH similar.

Install the RH and LH engine support insulator nuts.

- Tighten to 63 Nm (46 lb-ft).

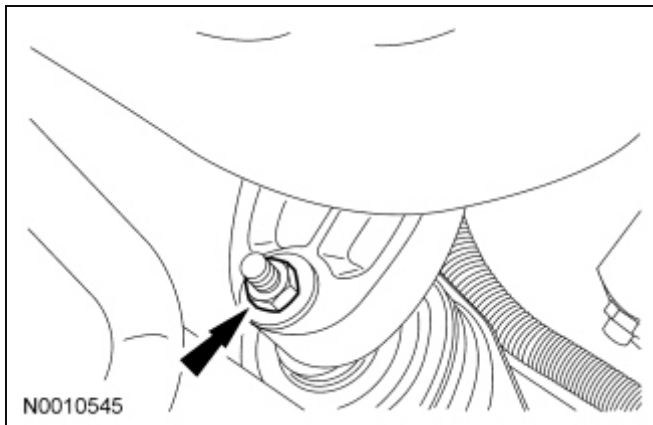

7. **NOTE:** Make sure the B+ cable is positioned close to the generator when the nut is being tightened.

Position the generator and install the B+ terminal and nut.

- Tighten to 8 Nm (71 lb-in).

8. Connect the generator electrical connector and pin-type retainers.
9. Install the 2 lower generator nuts.
 - Tighten to 25 Nm (18 lb-ft).
10. Install the 2 outer generator bracket bolts.
 - Tighten to 10 Nm (89 lb-in).

11. Install the radiator sight shield and 6 pin-type retainers.
12. Connect the **EVAP** canister purge valve vapor tube to the intake manifold. For additional information, refer to [Section 310-00](#).

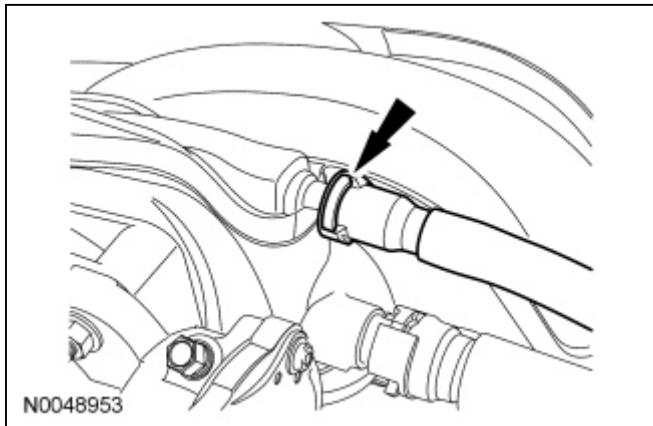

13. Install the **TB**. For additional information, refer to [Section 303-04B](#).
 14. Install the **ACL** assembly. For additional information, refer to [Section 303-12](#).
 15. Connect the battery ground cable. For additional information, refer to [Section 414-01](#).
-